

GENERAL NOTES

- SEE LIGHT FIXTURE SCHEDULE ON SHEET E-602.
- UNLESS NOTED OTHERWISE, THE LIGHTING SWITCHES AND OCCUPANCY SENSORS SHALL CONTROL THE LIGHTING FIXTURES WITHIN THE ROOMS THEY ARE LOCATED.
- LOCATION AND QUANTITY OF OCCUPANCY SENSORS IS DIAGNOSTIC. VERIFY LAYOUTS, QUANTITY, AND CONTROL WIRING WITH MANUFACTURER BEFORE PROCEEDING WITH ANY WORK. COORDINATE FINAL LOCATIONS OF SENSORS WITH OTHER EQUIPMENT.
- LIGHTING IN SPACES NOT SHOWN TO HAVE SWITCHES OR OCCUPANCY SENSORS SHALL BE CONTROLLED FROM LOCAL LIGHTING CONTROL PANEL.
- SEE REFLECTED CEILING PLAN ON A-104 FOR FIXTURE ALIGNMENT IN CEILING GRID.
- FOR ALL NORMALEMERGENCY LIGHTING FIXTURES, PROVIDE A UL LISTED GENERATOR TRANSFER DEVICE AND TWO CIRCUITS. ONE CIRCUIT SHALL BE CONNECTED TO THE NORMAL POWER AND LOCAL LIGHTING CONTROLS. THE OTHER CIRCUIT SHALL BE CONNECTED TO THE LIFE SAFETY PANEL FOR THAT AREA AND BYPASS LOCAL LIGHTING CONTROLS. SEE DETAILS ON SHEET E-501.

KEY NOTES

- EXISTING LIGHTING CONTROL PANEL FOR THE EXISTING RENOVATED AREA.
- LIGHTING FIXTURES IN THESE ROOMS/SPACES SHALL BE CONNECTED TO EXISTING LIGHTING CIRCUIT SERVING THIS AREA AS LISTED ON E-011. THIS APPLIES TO BOTH THE NORMAL LIGHTING CIRCUIT AND THE NORMALEMERGENCY LIGHTING CIRCUIT.
- RELOCATED LIGHT FIXTURE, TO BE INSTALLED AT ROOF PARAPET. SEE E-011 FOR MORE DETAILS.
- PROVIDE CAT6 CABLE IN 3/4" CONDUIT FROM LIGHTING RELAY PANEL TO ACCESS CONTROL SYSTEM IDF FOR LIGHTING CONTROL CONNECTION. COUNTY'S VENDOR WILL PROVIDE FINAL CONNECTION ON IDF SIDE AS WELL AS ACCESS CONTROL SYSTEM SIDE CONFIGURATION.

KEY PLAN

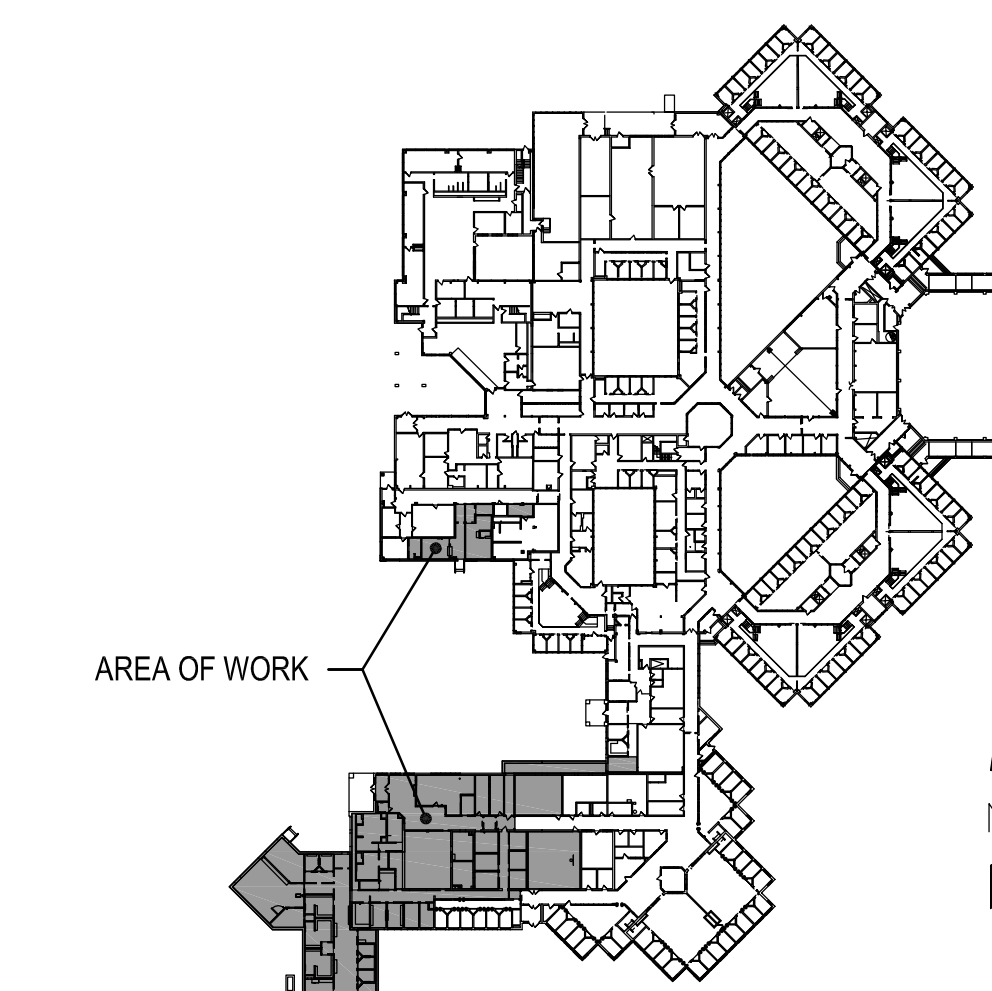

2 LOCKER ROOM/ARMORY AREA LIGHTING PLAN

SCALE: 1/8" = 1'-0"

0 4 8 16

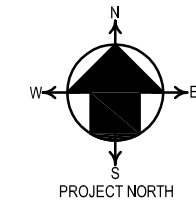

1 CENTRAL BOOKING AREA LIGHTING PLAN

SCALE: 1/8" = 1'-0"

0 4 8 16

